



STUMP PLANER OPERATION & MAINTENANCE

OPERATION

Fitting The Planer

Check that the planer is the correct model and type to fit the drill unit.

Ensure that the planer connections are clean before fitting.

Use suitably rated lifting equipment if required. See data plate for weight.

Position the planer in the vertical work position and support it so that it cannot fall over. Position the drill over the planer and align the pin holes. Lower the drill unit onto the planer and locate the drive pin. Secure the drive pin with linch pin.

Engaging Blades

The pilot engages with the top surface of the tree stump, drawing the tool down allowing the blades to engage with a clean horizontal cut. If the blades fail to engage, move the planer forwards and backwards until blades engage, then return tool to upright position.

Cutting Sequence

When removing large stumps, the planer can be repositioned to overlap each hole in the sequence shown. Repeat until the entire stump is removed.

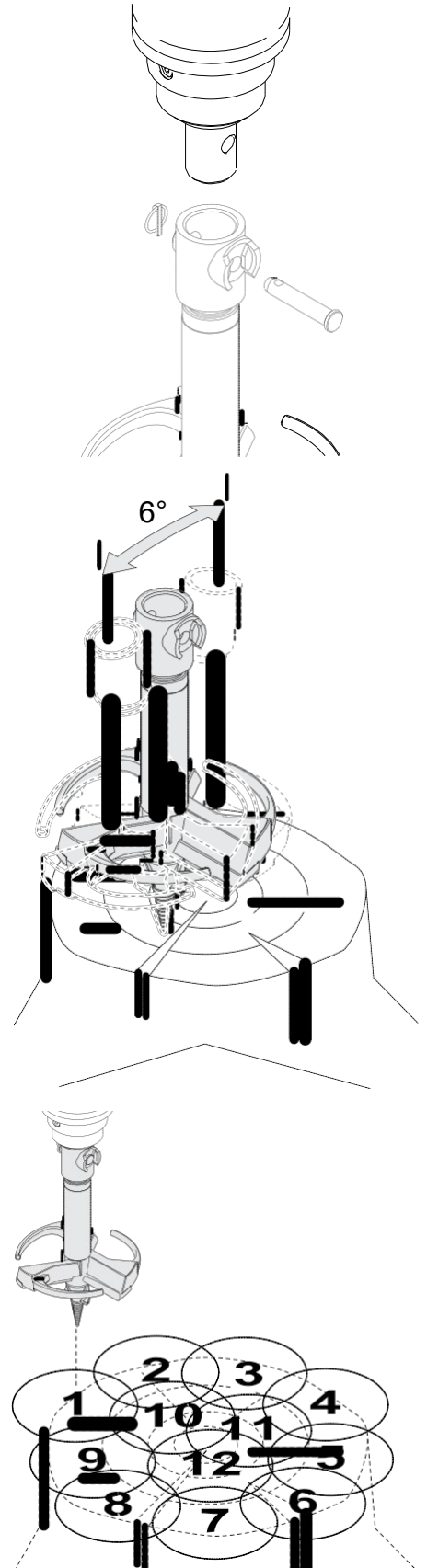



STUMP PLANER OPERATION & MAINTENANCE

MAINTENANCE

Removing & Sharpening Blades

In the unlikely event that the blades become damaged, they can be individually removed and sharpened. This process also applies when the blade loses its cutting edge due to wear.

Remove blades from planer by removing screws from underside of blades.

To sharpen the blade, first follow the removal process. Using a bench grinder fitted with a green silicon carbide, make several small passes against the cutting face ensuring that the cutting edge angle is maintained at 50 degrees.

Blade Life

After repeated sharpening, the blade will come to the end of its useful life. The diagram details acceptable levels of wear.

Pilot Replacement

Remove pilot using an 8mm hex key.

To separate the pilot from the pilot head, use a punch to drive the retaining pin out of the pilot. The pilot can then be withdrawn.

To install new pilot, reverse above instructions.

ENSURE PILOT IS TIGHT PRIOR TO USE.

